

Kenton C. Ward, CFM
Surveyor of Hamilton County
Phone (317) 776-8495
Fax (317) 776-9628

Suite 188
One Hamilton County Square
Noblesville, Indiana 46060-2230

July 5, 2011

To: Hamilton County Drainage Board

Re: Anna Kendall Drain

Attached is a petition and plans for the proposed relocation of the Anna Kendall Drain. The relocation is being proposed by the City of Westfield. The proposal is to reconstruct the portion of the drain that falls within the Westfield Grand Park area to provide an outlet for the Anna Kendall watershed area of Grand Park.

The line will consist of the following as shown on sheet LD600 of the plans for Grand Park by American Structurepoint, dated 6-28-11, and having job number 201100689:

101 feet of 36" RCP from Str. 20 to Str. 21

The total length of new drain shall be 101 feet. The 1615 feet of original drain between Sta. 0+00 and Sta. 16+15, per the original 1882 legal description shall be vacated. This proposal will remove 1514 feet from the total length of the Anna Kendall Drain.

The retention pond (lake) located upstream of Str. 20 is not to be considered part of the regulated drain. Only the outlet will be maintained as part of the regulated drain. The maintenance of the pond (lake) will be the responsibility of the City of Westfield. The Board will however retain jurisdiction for ensuring the storage volume for which the pond (lake) was designed will be retained. Thereby, allowing no fill or easement encroachments.

The cost of the relocation is to be paid by the City of Westfield.

Since this is a project by a municipal entity, City of Westfield, no bonds are required by the Drainage Board.

The parcels that will be affected by this relocation are:

Parcel
08-05-26-00-00-009.000

Owner
James Craig Wood and Sandra Malott Wood

08-05-26-00-00-011.000

James Craig Wood

The easement for the new drain will be 25 feet per half from the centerline of the new drain. The City of Westfield will provide written easement dedication and descriptions in the near future.

I recommend that the Board set a hearing for this drain for August 22, 2011.

Sincerely,

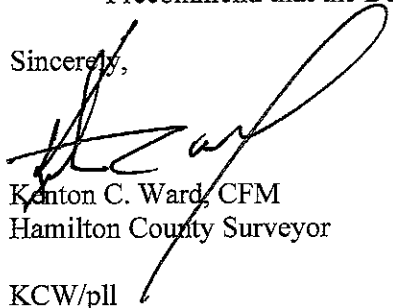

Kanton C. Ward, CFM
Hamilton County Surveyor

KCW/pll

Engineer's Opinion of Probable Cost of Construction

Project: Grand Park - Legal Drain Improvements
Project No: 2011.00689
Client: City of Westfield
Date: November 28, 2011
Prepared by: American Structurepoint, Inc.

Little Eagle Creek Arm Construction

Storm Sewer	Quantity	Unit	Unit Price	Extended Cost
36" RCP	2,387	LF	\$115.00	\$ 274,505.00
TYPE "J" MANHOLE	9	EA	\$2,600.00	\$ 23,400.00
CONCRETE END SECTION	1	EA	\$640.00	\$ 640.00
OUTLET CONTROL STRUCTURE	1	EA	\$5,000.00	\$ 5,000.00
Subtotal:				\$ 303,545.00

Anna Kendall Legal Drain Reconstruction

Storm Sewer	Quantity	Unit	Unit Price	Extended Cost
48" RCP	164	LF	\$125.00	\$ 20,500.00
CONCRETE ANCHOR	2	EA	\$1,000.00	\$ 2,000.00
Subtotal:				\$ 22,500.00

George Seybold Legal Drain Reconstruction

Storm Sewer	Quantity	Unit	Unit Price	Extended Cost
24" RCP	10	LF	\$56.50	\$ 565.00
48" RCP	1,780	LF	\$125.00	\$ 222,500.00
72" RCP	530	LF	\$250.00	\$ 132,500.00
TYPE "K" MANHOLE	12	EA	\$3,000.00	\$ 36,000.00
TYPE "M" MANHOLE	2	EA	\$5,500.00	\$ 11,000.00
CONCRETE ANCHOR	7	EA	\$1,000.00	\$ 7,000.00
CONCRETE END SECTION	1	EA	\$640.00	\$ 640.00
OUTLET CONTROL STRUCTURE	2	EA	\$5,000.00	\$ 10,000.00
Subtotal:				\$ 420,205.00
Contingency (5%)				37,312.50
Total:				783,562.50

HAMILTON COUNTY DRAINAGE BOARD
NOBLESVILLE, INDIANA

IN RE: Anna Kendall Drain)
Hamilton County, Indiana)

PETITION FOR RELOCATION AND RECONSTRUCTION

City of Westfield (hereinafter "Petitioner"),
hereby petitions the Hamilton County Drainage Board for authority to relocate and improve a
section of the Anna Kendall Drain, and in support of
said petition advises the Board that:

1. Petitioner owns real estate through which a portion of the Anna Kendall Drain runs.
2. Petitioner plans to develop its real estate with roads, buildings, utilities, storm drains, sanitary sewers and other structures.
3. Petitioner's proposed development of its real estate will require relocation and reconstruction of a portion of the Anna Kendall Drain, as specifically shown on engineering plans and specifications filed with the Hamilton County Surveyor.
4. The work necessary for the proposed relocation and reconstruction will be undertaken at the sole expense of the Petitioner and such work will result in substantial improvement to the Anna Kendall Drain, without cost to other property owners on the watershed of the Anna Kendall Drain.
5. Proposed relocation and reconstruction will not adversely affect other land owners within the drainage shed.
6. Petitioner requests approval of the proposed relocation and reconstruction under IC 36-9-27-52.5.

WHEREFORE, Petitioner requests that an Order issued from the Hamilton County Drainage Board authorizing relocation and reconstruction of the Anna Kendall Drain, in conformance with applicable law and plans and specifications on file with the Hamilton County Surveyor.

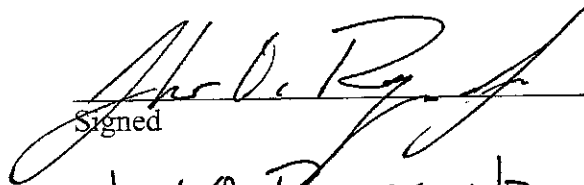
Signed
JOHN O. ROGERS, JR
Printed

FINDINGS AND ORDER

CONCERNING THE PARTIAL VACATION OF THE

Anna Kendall Drain

Station 0+00 to Station 16+15

On this **12th day of September, 2011**, the Hamilton County Drainage Board has held a hearing on the Maintenance Report and Schedule of Assessments of the **Cool Creek Drain, George Seybold Arm, Station 0+00 to Station 16+15**.

Evidence has been heard. Objections were presented and considered. The Board then adopted an order of action. The Board now finds that the costs of continued maintenance to the portion of the above drain exceed the benefits to the real estate benefited by the portion of the drain to be abandoned and issues this order vacating the above section of the **Cool Creek Drain, George Seybold Arm, Station 0+00 to Station 16+15**.

HAMILTON COUNTY DRAINAGE BOARD



President

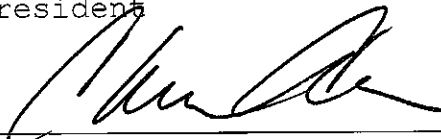

Member

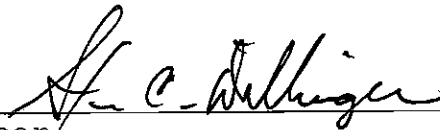

Member

Attest:



STATE OF INDIANA)
) ss:
COUNTY OF HAMILTON)

BEFORE THE HAMILTON COUNTY
DRAINAGE BOARD
NOBLESVILLE, INDIANA

IN THE MATTER OF THE
RECONSTRUCTION OF THE
Anna Kendall Drain

FINDINGS AND ORDER FOR RECONSTRUCTION

The matter of the proposed Reconstruction of the **Anna Kendall Drain** came before the Hamilton County Drainage Board for hearing on **September 12, 2011**, on the Reconstruction Report consisting of the report and the Schedule of Damages and Assessments. The Board also received and considered the written objection of an owner of certain lands affected by the proposed Reconstruction, said owner being:

Evidence was heard on the Reconstruction Report and on the aforementioned objections.

The Board, having considered the evidence and objections, and, upon motion duly made, seconded and unanimously carried, did find and determine that the costs, damages and expenses of the proposed Reconstruction will be less than the benefits accruing to the owners of all land benefited by the Reconstruction.

The Board having considered the evidence and objections, upon motion duly made, seconded and unanimously carried, did adopt the Schedule of Assessments as proposed, subject to amendment after inspection of the subject drain as it relates to the lands of any owners which may have been erroneously included or omitted from the Schedule of Assessments.

The Board further finds that it has jurisdiction of these proceedings and that all required notices have been duly given or published as required by law.

Wherefore, it is ORDERED, that the proposed Reconstruction of the **Anna Kendall Drain** be and is hereby declared established.

Thereafter, the Board made inspection for the purpose of determining whether or not the lands of any owners had been erroneously included or excluded from the Schedule of Assessments. The Board finds on the basis of the reports and findings at this hearing as follows:

HAMILTON COUNTY DRAINAGE BOARD



PRESIDENT

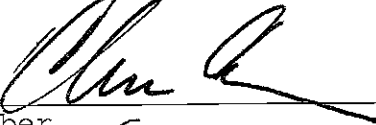

Member

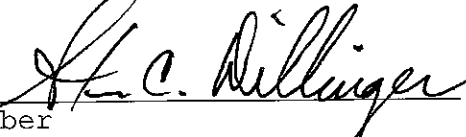

Member

ATTEST:

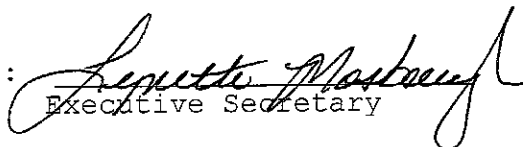
Executive Secretary

BEFORE THE HAMILTON COUNTY DRAINAGE BOARD
IN THE MATTER OF

Anna Kendall Drain

NOTICE

To Whom It May Concern and: _____

Notice is hereby given of the hearing of the Hamilton County Drainage Board concerning the reconstruction of the **Anna Kendall Drain** on **August 22, 2011**, at **9:15 A.M.** in Commissioners Court, Hamilton County Judicial Center, One Hamilton County Square, Noblesville, Indiana. Construction and maintenance reports of the Surveyor and the Schedule of Assessments proposed by the Drainage Board have been filed and are available for public inspection in the office of the Hamilton County Surveyor.

Hamilton County Drainage Board

Attest: Lynette Mosbaugh

ONE TIME ONLY

STATE OF INDIANA)
) SS BEFORE THE HAMILTON
)
COUNTY OF HAMILTON) DRAINAGE BOARD

IN THE MATTER OF **Anna Kendall Drain**

NOTICE

Notice is hereby given that the Hamilton County Drainage Board at its regular meeting **September 12, 2011** adopted the reconstruction report of the Surveyor and the Amended Schedule of damages and assessments including annual assessment for periodic maintenance, finding that the costs, damages and expense of the proposed improvement would be less than the benefits which will result to the owner of lands benefited thereby.

The Board issued an order declaring the proposed improvement established. Such findings and order were marked filed and are available for inspection in the Office of the Hamilton County Surveyor.

If judicial review of the findings and order of the Board is not requested pursuant to Article VIII of the 1965 Indiana Drainage Code as amended within twenty (20) days from the date of publication of this notice, the findings and order shall become conclusive.

HAMILTON COUNTY DRAINAGE BOARD

BY: Steven A. Holt
PRESIDENT

ATTEST: Lynette Mosbaugh
SECRETARY

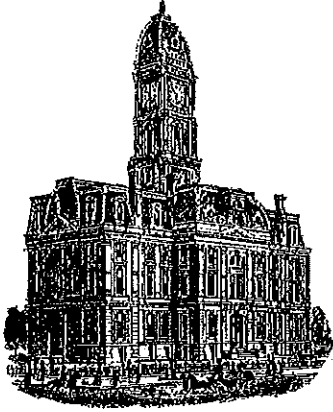

Kenton C. Ward, CFM
Surveyor of Hamilton County
Phone (317) 776-8495
Fax (317) 776-9628

Suite 188
One Hamilton County Square
Noblesville, Indiana 46060-2230

To: Hamilton County Drainage Board

January 8, 2016

Re: Anna Kendall Drain – Grand Park Reconstruction

Attached are as-built, certificate of completion & compliance, and other information for the Grand Park Reconstruction of the Anna Kendall Drain. An inspection of the drainage facilities for this section has been made and the facilities were found to be complete and acceptable.

During construction, changes were made to the drain, which will alter the plans submitted with my report for this drain-dated July 5, 2011. The report was approved by the Board at the hearing held September 12, 2011. (See Drainage Board Minutes Book 13, Pages 564-566)

The changes are as follows:

The 36" RCP was upsized to 164 feet of 48" RCP

The length of the drain due to the changes described above is now **164 feet**.

The drainage easement was set at 25 feet per half and recorded under instrument #2011044023. Sureties were not required for this project as it was paid for by the City of Westfield.

I recommend the Board approve the drain's construction as complete and acceptable.

Sincerely,



Kenton C. Ward, CFM
Hamilton County Surveyor

CERTIFICATE OF COMPLETION AND COMPLIANCE

To: Hamilton County Surveyor

Re: Grand Park Legal Drain Relocation - Danny Kendall (Coral Creek)

I hereby certify that:

1. I am a Registered Land Surveyor or Engineer in the State of Indiana.
2. I am familiar with the plans and specifications for the above referenced subdivision.
3. I have personally observed and supervised the completion of the drainage facilities for the above referenced subdivision.
4. The drainage facilities within the above referenced subdivision to the best of my knowledge, information and belief have been installed and completed in conformity with all plans and specifications.
5. The drainage facilities within the above referenced subdivision to the best of my knowledge, information and belief have been correctly represented on the Record Drawings, Digital Record Drawings and the Structure Data Spreadsheet.

Signature: [Signature] Date: 1/27/15

Type or Print Name: BRADLEY SCHRAGE

Business Address: American Structure point, Inc
9260 Shadeland Station
Indianapolis, IN 46256

Telephone Number: 317-547-5580



INDIANA REGISTRATION NUMBER
PE11100062

PRINT DATE: 9/19/12 12:08 PM EDIT DATE: 9/19/12 12:08 PM DRAWING FILE: P:\2011\0689\DRAWINGS\CIVIL\PLAN SET\MASS GRADING\02011\0689.CE\17\LD400.STMP.DWG
 PLOT SCALE: 1:1 EDIT BY: PROTERY

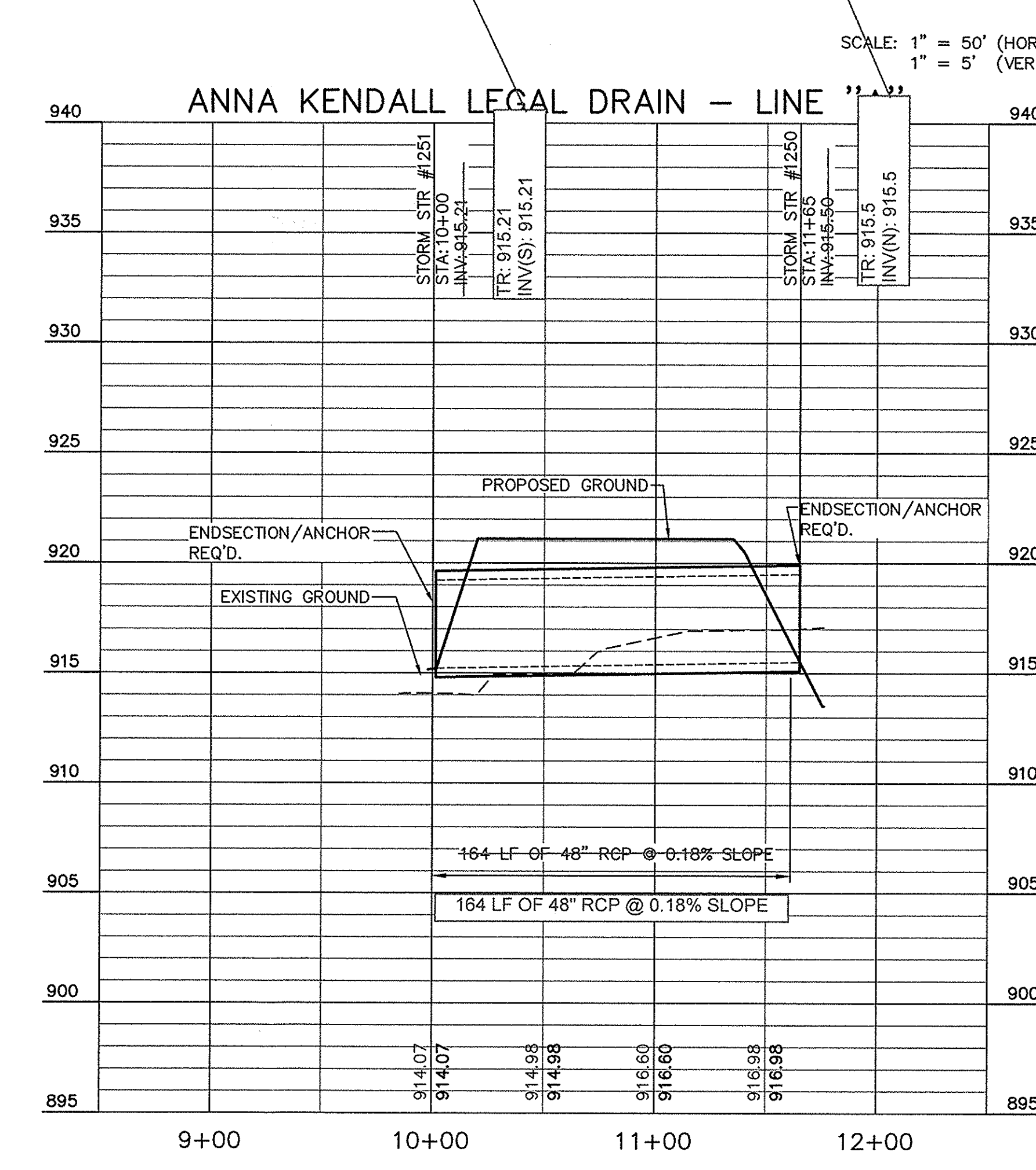
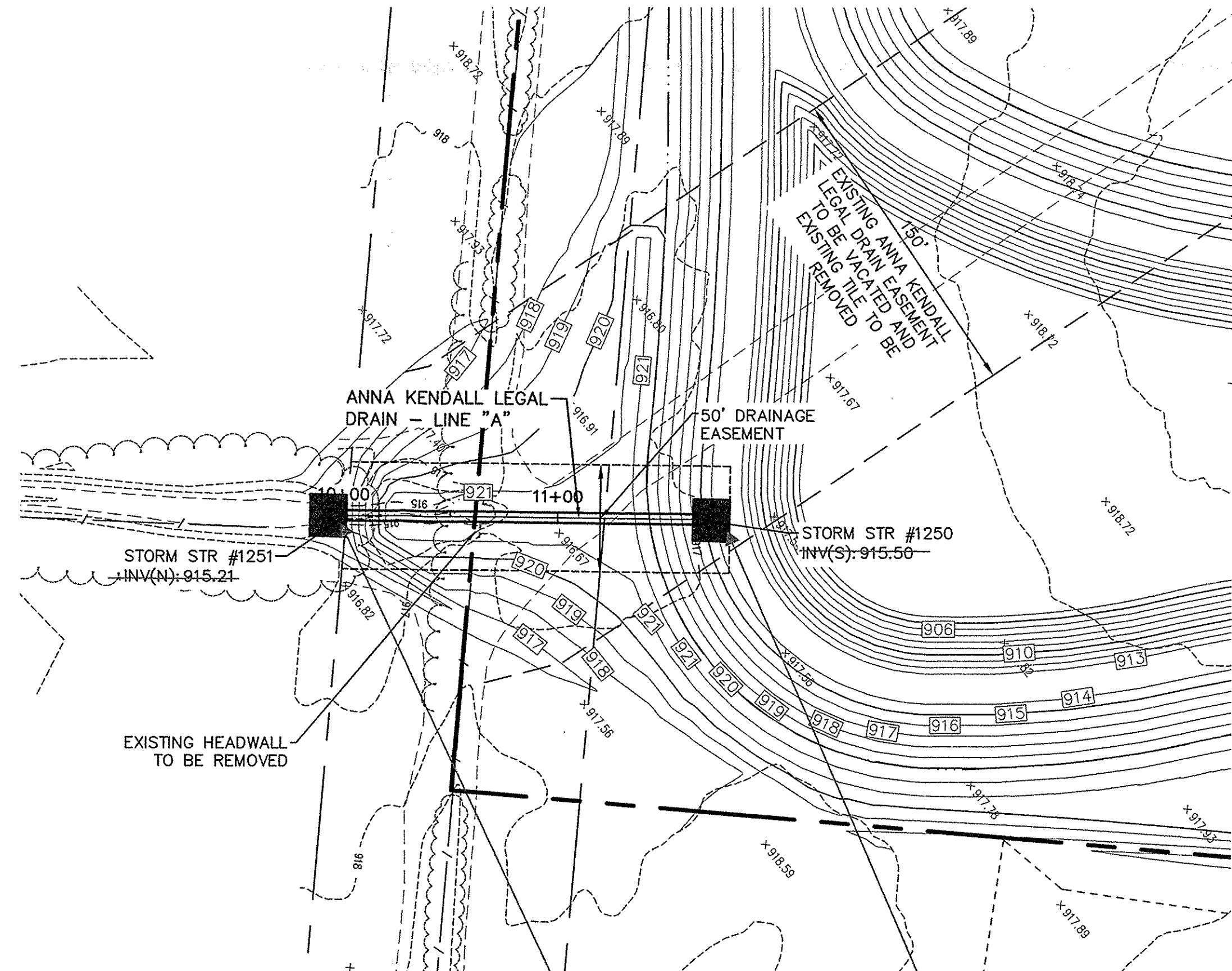

DEMOLITION NOTES:

- ALL WORK TO CONFORM TO FEDERAL, STATE AND LOCAL REGULATIONS.
- CONTRACTOR SHALL KEEP ADJOINING PROPERTIES CLEAN OF CONSTRUCTION DEBRIS AND CONSTRUCTION TRAFFIC AT ALL TIMES.
- CLEAR AND GRUB ALL TREES AND VEGETATION NECESSARY FOR CONSTRUCTION.
- PROTECT TREES TO REMAIN DURING CONSTRUCTION. PROVIDE TREE PROTECTION FENCING AT THE TREE DRIP LINE.
- STORAGE OF MATERIALS AND PARKING OF EQUIPMENT AND VEHICLES BELOW TREE CANOPIES WITHIN THE TREE DRIP LINE IS PROHIBITED.
- THE CONTRACTOR SHALL REMOVE AND DISPOSE OF ALL EXISTING STRUCTURES, FENCES, CONCRETE, ASPHALT PAVEMENT AND OTHER MISCELLANEOUS APPURTENANCES ON SITE, UNLESS NOTED TO REMAIN ON THE CONTRACT DRAWINGS.
- THE USE OF ANY TYPE OF EXPLOSIVES WILL NOT BE PERMITTED.
- CONDUCT DEMOLITION AND CONSTRUCTION OPERATIONS TO ENSURE MINIMAL INTERFERENCE WITH STREETS, WALKS AND OTHER ADJACENT OCCUPIED FACILITIES.
- DO NOT CLOSE OR OBSTRUCT STREETS, WALKS OR OTHER OCCUPIED FACILITIES WITHOUT PERMISSION FROM THE LOCAL AUTHORITIES HAVING JURISDICTION. PROVIDE ALTERNATE ROUTES AROUND CLOSED OR OBSTRUCTED TRAFFIC WAYS, IF REQUIRED BY GOVERNING AUTHORITIES.
- ENSURE SAFE PASSAGE OF PERSONS AROUND AREAS OF DEMOLITION AND CONSTRUCTION. CONDUCT OPERATIONS TO PREVENT DAMAGE TO ADJACENT STRUCTURES AND OTHER FACILITIES AND INJURY TO PERSONS.
- PROMPTLY REPAIR DAMAGE TO ADJACENT FACILITIES CAUSED BY DEMOLITION AND CONSTRUCTION OPERATIONS.
- ALL UTILITY INFORMATION SHALL BE VERIFIED BY THE CONTRACTOR. CONTACT AMERICAN STRUCTUREPOINT IF ANY VARIATION EXISTS.
- MAINTAIN EXISTING UTILITIES TO REMAIN IN SERVICE AND PROTECT AGAINST DAMAGE DURING DEMOLITION AND CONSTRUCTION OPERATIONS.
- ALL UTILITIES TO BE REMOVED SHALL BE DISCONNECTED AND CAPPED AT THE NEAREST CONNECTION POINT.

GENERAL GRADING NOTES:

- ALL WORK TO CONFORM TO STATE AND LOCAL REGULATIONS.
- SITE GRADING SHALL NOT PROCEED UNTIL EROSION CONTROL MEASURES HAVE BEEN INSTALLED.
- THE CONTRACTOR SHALL VERIFY ALL DIMENSIONS (VERTICAL AND HORIZONTAL) IN THE FIELD PRIOR TO STARTING CONSTRUCTION. THE CONTRACTOR SHALL BE RESPONSIBLE FOR ALL FIELD DIMENSIONS. IF ANY DISCREPANCIES ARE FOUND IN THESE PLANS FROM THE ACTUAL FIELD CONDITIONS, THE CONTRACTOR SHALL NOTIFY THE ENGINEER IMMEDIATELY.
- THE EXCAVATING CONTRACTOR MUST TAKE PARTICULAR CARE WHEN EXCAVATING IN AND AROUND EXISTING UTILITY LINES AND EQUIPMENT. VERIFY COVER REQUIREMENTS BY UTILITY CONTRACTOR'S AND/OR UTILITY COMPANIES SO AS NOT TO CAUSE DAMAGE.
- THE CONTRACTOR SHALL NOTIFY ALL UTILITY COMPANIES 72 HOURS BEFORE CONSTRUCTION IS TO START, TO VERIFY IF ANY UTILITIES ARE PRESENT ON SITE. ALL VERIFICATIONS (location, size and depth) SHALL BE MADE BY THE APPROPRIATE UTILITY COMPANIES. WHEN EXCAVATING AROUND OR OVER EXISTING UTILITIES, THE CONTRACTOR MUST NOTIFY THE UTILITY COMPANY SO A REPRESENTATIVE OF THAT UTILITY COMPANY CAN BE PRESENT TO INSTRUCT AND OBSERVE DURING CONSTRUCTION.
- TRENCHES FOR ALL STORM DRAIN LINES SHALL BE BACKFILLED COMPLETELY WITH GRANULAR MATERIAL IF WITHIN 5 FEET OF PAVEMENT.
- AFTER STRIPPING TOPSOIL MATERIAL, PROOFROLL WITH A MEDIUM WEIGHT ROLLER TO DETERMINE LOCATIONS OF ANY POCKETS OF UNSUITABLE MATERIAL. THE NECESSITY FOR SUBDRAINS AND/OR REMOVAL OF ANY UNSUITABLE MATERIAL WITHIN THE PROPOSED PARKING AREAS WILL BE DETERMINED AT THE TIME OF CONSTRUCTION.

DEMOLITION NOTES:

- ALL WORK TO CONFORM TO FEDERAL, STATE AND LOCAL REGULATIONS.
- CONTRACTOR SHALL KEEP ADJOINING PROPERTIES CLEAN OF CONSTRUCTION DEBRIS AND CONSTRUCTION TRAFFIC AT ALL TIMES.
- CLEAR AND GRUB ALL TREES AND VEGETATION NECESSARY FOR CONSTRUCTION.
- PROTECT TREES TO REMAIN DURING CONSTRUCTION. PROVIDE TREE PROTECTION FENCING AT THE TREE DRIP LINE.
- STORAGE OF MATERIALS AND PARKING OF EQUIPMENT AND VEHICLES BELOW TREE CANOPIES WITHIN THE TREE DRIP LINE IS PROHIBITED.
- THE CONTRACTOR SHALL REMOVE AND DISPOSE OF ALL EXISTING STRUCTURES, FENCES, CONCRETE, ASPHALT PAVEMENT AND OTHER MISCELLANEOUS APPURTENANCES ON SITE, UNLESS NOTED TO REMAIN ON THE CONTRACT DRAWINGS.
- THE USE OF ANY TYPE OF EXPLOSIVES WILL NOT BE PERMITTED.
- CONDUCT DEMOLITION AND CONSTRUCTION OPERATIONS TO ENSURE MINIMAL INTERFERENCE WITH STREETS, WALKS AND OTHER ADJACENT OCCUPIED FACILITIES.
- DO NOT CLOSE OR OBSTRUCT STREETS, WALKS OR OTHER OCCUPIED FACILITIES WITHOUT PERMISSION FROM THE LOCAL AUTHORITIES HAVING JURISDICTION. PROVIDE ALTERNATE ROUTES AROUND CLOSED OR OBSTRUCTED TRAFFIC WAYS, IF REQUIRED BY GOVERNING AUTHORITIES.
- ENSURE SAFE PASSAGE OF PERSONS AROUND AREAS OF DEMOLITION AND CONSTRUCTION. CONDUCT OPERATIONS TO PREVENT DAMAGE TO ADJACENT STRUCTURES AND OTHER FACILITIES AND INJURY TO PERSONS.
- PROMPTLY REPAIR DAMAGE TO ADJACENT FACILITIES CAUSED BY DEMOLITION AND CONSTRUCTION OPERATIONS.
- ALL UTILITY INFORMATION SHALL BE VERIFIED BY THE CONTRACTOR. CONTACT AMERICAN STRUCTUREPOINT IF ANY VARIATION EXISTS.
- MAINTAIN EXISTING UTILITIES TO REMAIN IN SERVICE AND PROTECT AGAINST DAMAGE DURING DEMOLITION AND CONSTRUCTION OPERATIONS.
- ALL UTILITIES TO BE REMOVED SHALL BE DISCONNECTED AND CAPPED AT THE NEAREST CONNECTION POINT.

GENERAL GRADING NOTES:

- ALL WORK TO CONFORM TO STATE AND LOCAL REGULATIONS.
- SITE GRADING SHALL NOT PROCEED UNTIL EROSION CONTROL MEASURES HAVE BEEN INSTALLED.
- THE CONTRACTOR SHALL VERIFY ALL DIMENSIONS (VERTICAL AND HORIZONTAL) IN THE FIELD PRIOR TO STARTING CONSTRUCTION. THE CONTRACTOR SHALL BE RESPONSIBLE FOR ALL FIELD DIMENSIONS. IF ANY DISCREPANCIES ARE FOUND IN THESE PLANS FROM THE ACTUAL FIELD CONDITIONS, THE CONTRACTOR SHALL NOTIFY THE ENGINEER IMMEDIATELY.
- THE EXCAVATING CONTRACTOR MUST TAKE PARTICULAR CARE WHEN EXCAVATING IN AND AROUND EXISTING UTILITY LINES AND EQUIPMENT. VERIFY COVER REQUIREMENTS BY UTILITY CONTRACTOR'S AND/OR UTILITY COMPANIES SO AS NOT TO CAUSE DAMAGE.
- THE CONTRACTOR SHALL NOTIFY ALL UTILITY COMPANIES 72 HOURS BEFORE CONSTRUCTION IS TO START, TO VERIFY IF ANY UTILITIES ARE PRESENT ON SITE. ALL VERIFICATIONS (location, size and depth) SHALL BE MADE BY THE APPROPRIATE UTILITY COMPANIES. WHEN EXCAVATING AROUND OR OVER EXISTING UTILITIES, THE CONTRACTOR MUST NOTIFY THE UTILITY COMPANY SO A REPRESENTATIVE OF THAT UTILITY COMPANY CAN BE PRESENT TO INSTRUCT AND OBSERVE DURING CONSTRUCTION.
- TRENCHES FOR ALL STORM DRAIN LINES SHALL BE BACKFILLED COMPLETELY WITH GRANULAR MATERIAL IF WITHIN 5 FEET OF PAVEMENT.
- AFTER STRIPPING TOPSOIL MATERIAL, PROOFROLL WITH A MEDIUM WEIGHT ROLLER TO DETERMINE LOCATIONS OF ANY POCKETS OF UNSUITABLE MATERIAL. THE NECESSITY FOR SUBDRAINS AND/OR REMOVAL OF ANY UNSUITABLE MATERIAL WITHIN THE PROPOSED PARKING AREAS WILL BE DETERMINED AT THE TIME OF CONSTRUCTION.

NOTE:
 ALL MAINTENANCE OF TRAFFIC SIGNAGE METHODS, MATERIALS AND CONSTRUCTION DETAILS FOR WORK WITHIN PUBLIC RIGHT-OF-WAY SHALL CONFORM TO HAMILTON COUNTY REQUIREMENTS, INDOT STANDARD DETOUR SHEETS AND SPECIFICATIONS AND THE INDIANA MANUAL ON UNIFORM TRAFFIC CONTROL DEVICES. THIS INCLUDES PLACING ROAD CONSTRUCTION AHEAD SIGNS, LANE MERGING SIGNS, FLASHING ARROW SIGNS, CONSTRUCTION BARRELS, ETC.

NOTE:
 REFER TO SS SHEETS FOR STORM SEWER STRUCTURE DATA TABLE.

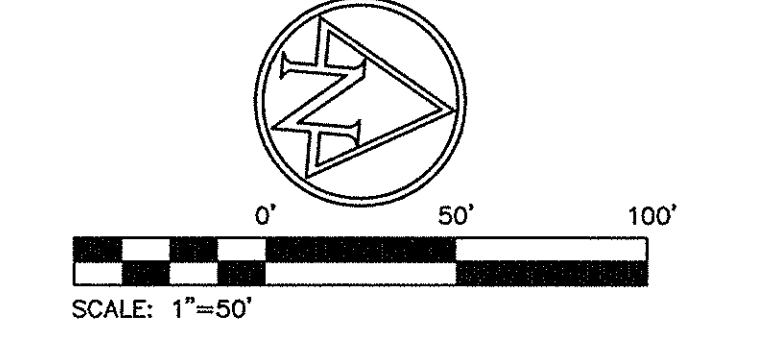

- PROPOSED LEGEND**
- GRANULAR BACKFILL
 - EXISTING PAVEMENT TO BE REMOVED
 - PAVEMENT TO BE SAWCUT
 - RIPRAP RAP RENO MATTRESS OUTLET PROTECTION

- EXISTING LEGEND**
- SPOT ELEVATION
 - POWER POLE
 - LIGHT POLE
 - GUY WIRE
 - MAG NAIL FOUND
 - REBAR FOUND
 - IRON PIN
 - SSN
 - CABLE BOX
 - AIR CONDITIONING UNIT
 - TREE
 - PINE TREE
 - MAILBOX
 - FENCE POST
 - GAS MARKER
 - ELECTRIC BOX
 - TELEPHONE PEDESTAL
 - ELECTRIC METER
 - OVERHEAD ELECTRIC
 - CABLE SERVICE
 - GAS MAIN
 - FENCE

- NOTES:**
- CONTRACTOR SHALL PROTECT AND NOT DESTROY THE PROPERTY CORNER MONUMENTS DURING CONSTRUCTION.
 - CONTRACTOR TO VERIFY LOCATION, SIZE AND DEPTH OF EXISTING UTILITIES PRIOR TO COMMENCING ANY CONSTRUCTION. CONTACT ENGINEER IF VARIATION EXISTS.
 - CONTRACTOR TO NOTIFY ENGINEER IMMEDIATELY OF ANY OBSTRUCTIONS WITHIN THE ALIGNMENT OF THE LEGAL DRAINS NOT NOTED ON THESE PLANS.
 - PROPOSED GRADE ABOVE LEGAL DRAINS TO MATCH EXISTING GRADE UNLESS OTHERWISE NOTED.
 - CONTRACTOR TO LOCATE, PERPETUATE AND RE-ESTABLISH ALL EXISTING FIELD TIES LOCATED DURING CONSTRUCTION. CONTRACTOR TO CONTACT AND COORDINATE ALL PERPETUATION EFFORTS WITH THE ENGINEER.

- GAS LINE NOTES:**
- CONTRACTOR SHALL NOTIFY VECTREN PIPELINE AND BUCKEYE PARTNERS L.P. PRIOR TO COMMENCING ANY WORK WITHIN 100' OF PIPELINE EASEMENTS.
 - CONTRACTOR SHALL CONTACT VECTREN PIPELINE AND BUCKEYE PARTNERS L.P. TO VERIFY THE DEPTH OF THE EXISTING PIPELINES AND NOTIFY ENGINEER ABOUT FINDINGS PRIOR TO COMMENCING ANY CONSTRUCTION.
 - ALL PIPELINE UTILITY CROSSINGS AND TEMPORARY TRAFFIC CROSSINGS DURING CONSTRUCTION SHALL BE COORDINATED WITH VECTREN PIPELINE AND BUCKEYE PARTNERS L.P. AND CONSTRUCTED IN ACCORDANCE WITH THEIR GUIDELINES FOR CROSSING GAS PIPELINES.

CAUTION !!
 THE LOCATIONS OF ALL EXISTING UNDERGROUND UTILITIES SHOWN ON THIS PLAN ARE BASED UPON ABOVE GROUND EVIDENCE (including, but not limited to, manholes, inlets, valves, and marks made upon the ground by others) AND ARE SPECULATIVE IN NATURE. THERE MAY ALSO BE OTHER EXISTING UNDERGROUND UTILITIES FOR WHICH THERE IS NO ABOVE GROUND EVIDENCE OR FOR WHICH NO ABOVE GROUND EVIDENCE WAS OBSERVED. THE EXACT LOCATIONS OF SAID EXISTING UNDERGROUND UTILITIES SHALL BE VERIFIED BY THE CONTRACTOR PRIOR TO ANY AND ALL CONSTRUCTION.
 811 OR 1-800-382-5544
 CALL TOLL FREE
 - INDIANA UNDERGROUND -

This information was gathered for input into the Hamilton County Geographic Information System (GIS). This document is considered an official record of the GIS.
 Entry Date: 9/19/12
 Entered By: SLN

7055 BARRE LANE, SUITE 100
 INDIANAPOLIS, IN 46254-3097
 TEL 317.547.5550 FAX 317.543.0270
 www.structurepoint.com
AMERICAN STRUCTUREPOINT INC.

SHAWN A. COLE
 REGISTERED PROFESSIONAL ENGINEER
 No. PE 1070749
 STATE OF INDIANA
 CERTIFIED BY 11/03/11

ANNA KENDALL LEGAL DRAIN PLAN & PROFILE
 PREPARED FOR:
CITY OF WESTFIELD
 130 PENN STREET
 WESTFIELD, INDIANA 46074

PROJECT:
GRAND PARK AT WESTFIELD
 WESTFIELD, INDIANA

DATE:	7/24/11
CHK'D BY:	SAC
DRAWN BY:	PEJ
JOB NO.	20110689
REVISIONS	
ADDENDUM	8/9/2011
ADDENDUM	8/12/2011
EC REV'S	8/26/2011
FOR CONST.	11/03/2011
COMMENTS	12/01/2011
SMI REV.	01/17/2012
WAT. REV.	01/27/2012

SHEET NO.
LD400
 OF